

# LUDECKE

Since 1930. The perfect connection.

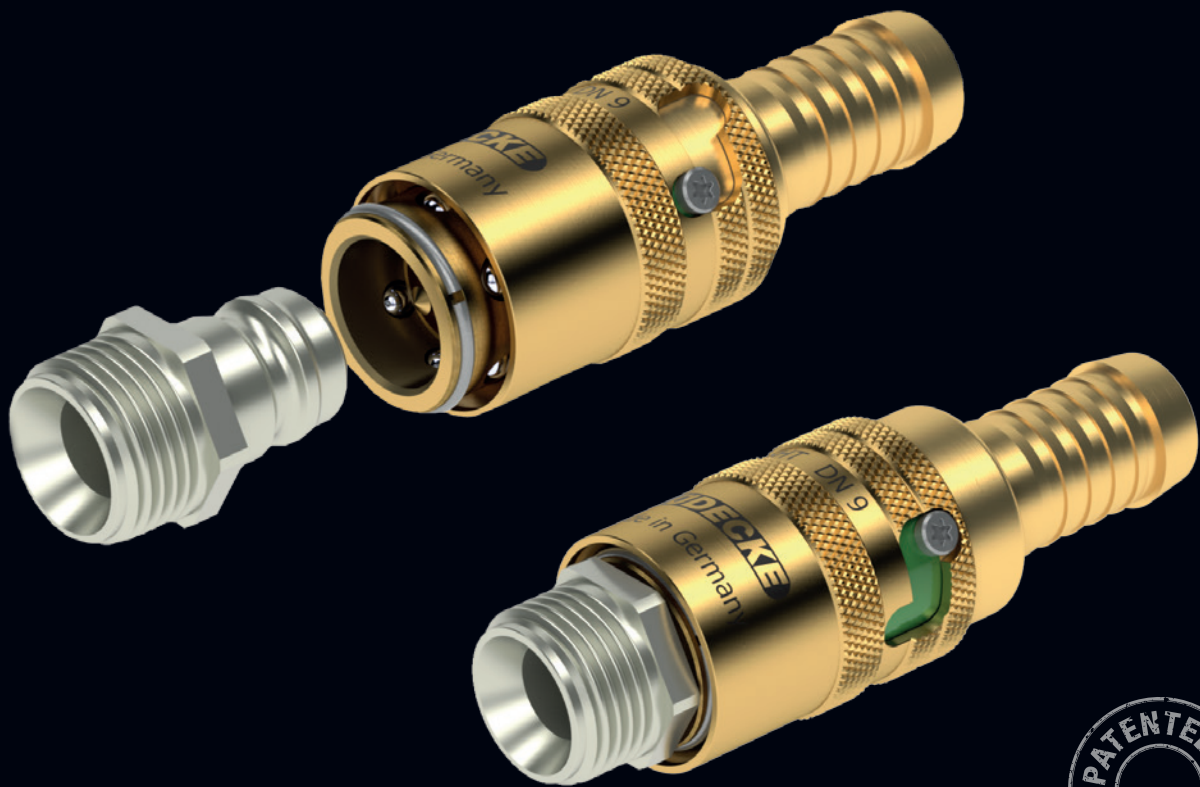

## Temperature Regulation Quick Connect Coupling System with Automatic Safety Locking Mechanism

Edition 1.1

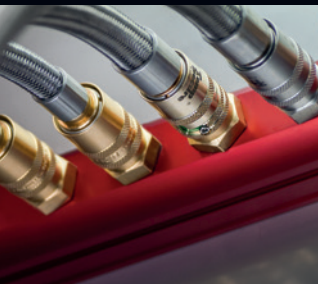

**Temp<sup>®</sup>  
Secure**  
by **LUDECKE**



**LUDECKE** MADE IN GERMANY 

# Patented Safety for Maximum Reliability



The patented TempSecure by **LUDECKE**® temperature regulation quick connect coupling system features an automatic safety locking mechanism which prevents unintentional disconnection and unlocking.

As a result, this coupling is especially suited when using aggressive media as well as for temperature regulation applications with warm or hot water and tempered oil between +20°C and +220°C\*. Superior FKM O-rings make the coupling an ideal media carrier especially in high-temperature applications.

\*subject to used media

#### Advantages:

- Maximum safety against unintended disconnection and unlocking
- Simple and intuitive coupling process
- High-temperature seals for best performance
- Versions with additional O-ring sealing at connection port to prevent leakage in high-temperature applications
- Available for almost all **LUDECKE** temperature regulation series in various sizes, materials, connection and valve types

**TempSecure**<sup>®</sup>  
by **LUDECKE**

## The Guardian Angel for the Plastics Processing Industry

TempSecure by **LUDECKE**® temperature regulation quick connect couplings - highest flexibility due to different sizes and connection types.



# High-Quality Materials

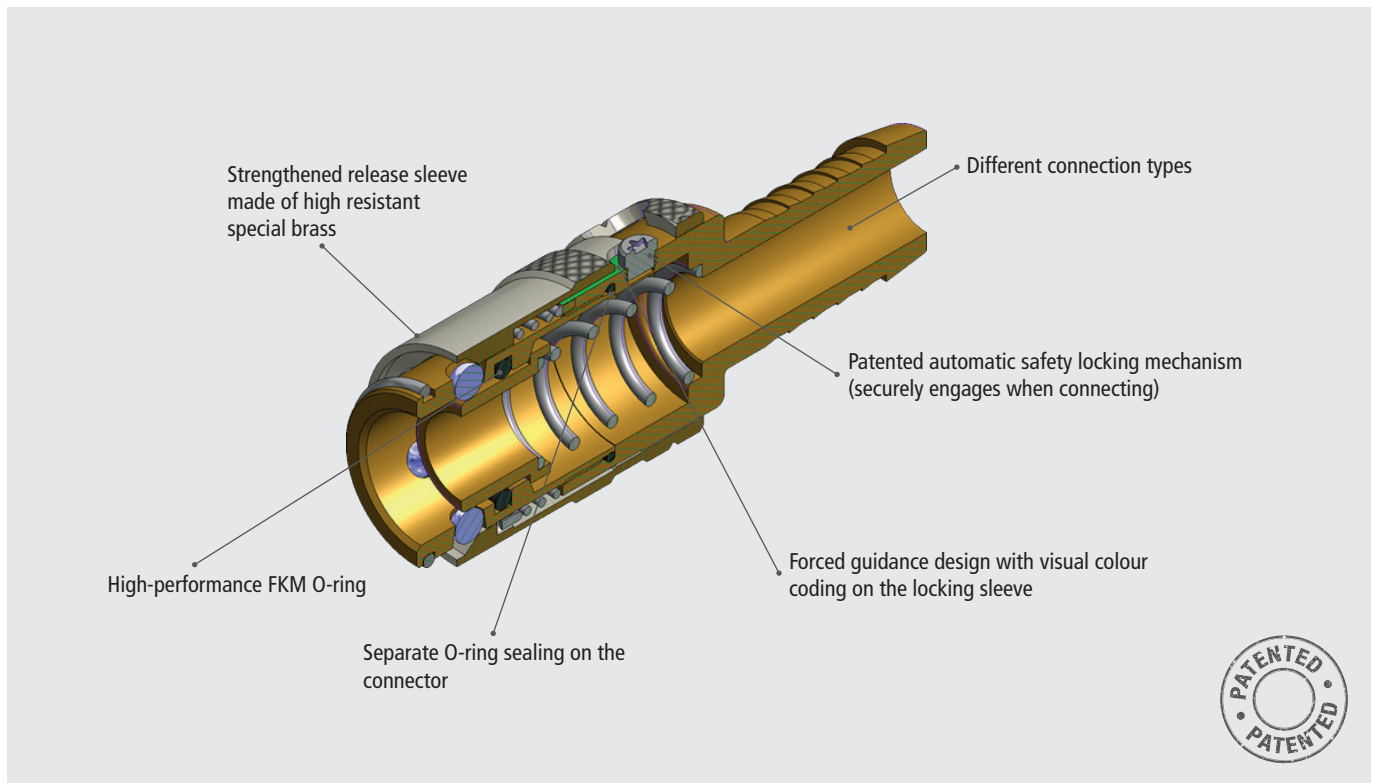

# Easy - Reliable - Quick

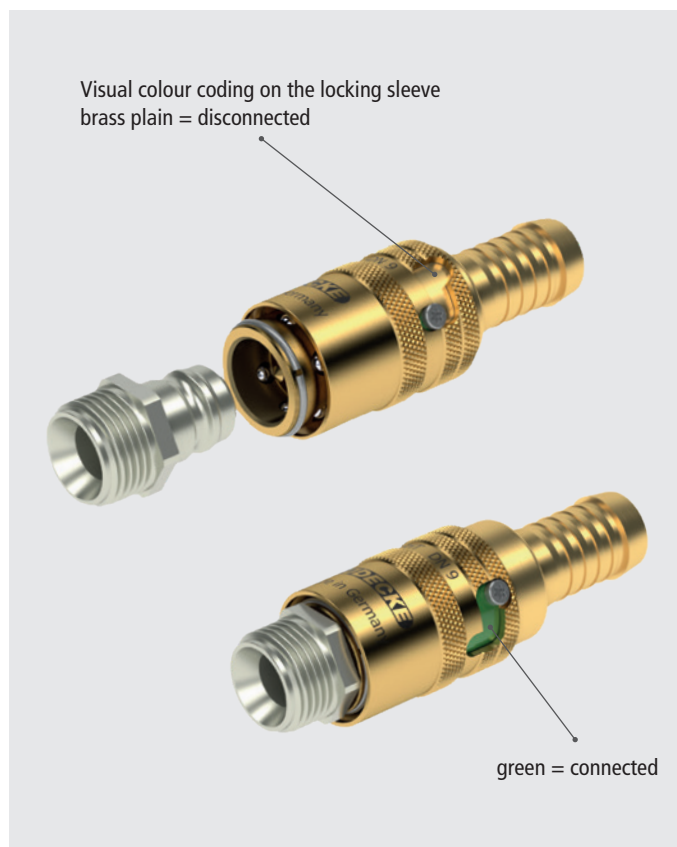

The TempSecure by **LUDECKE**® temperature regulation quick connect coupling system is characterized by its simple and intuitive connecting process. Even under difficult circumstances and obstructed view, this enables safe operation.

The connection is made via automatic locking. An additional colour coding on the locking sleeve clearly indicates correct and secure connection.

The disconnecting process can be performed blindly due to the forced guidance of the locking sleeve. However, this requires a deliberate manual unlocking effort. An accidental or unintentional disconnection is almost impossible.



# Functional Principle:



Coupling with one-hand operation - To connect the system, simply push the plug into the safety coupling. The release sleeve automatically slides forward in a twisting motion and engages into the final safety lock position. The coupling is now firmly connected to the plug and secured against unintentional opening.



To release the plug from the safety coupling, the sleeve has to be pulled back manually and with force. The plug can only be removed from the safety coupling by deliberately pulling/ twisting.

# High-Performance FKM



The temperature regulation couplings of the TempSecure by **LUDECKE**® series contain a high-performance FKM sealing ring which has been developed for the special requirements of high-temperature applications.

- Extreme heat resistance up to 220°C continuous temperature (oil: 220°C, water: 180°C, air: 220°C)
- High resistance against synthetic oils used as tempered media
- Very good chemical resistance and high resistance against aliphatic hydrocarbons (fuels)
- Steam/ hot water optimised

On request, the high-performance FKM sealing ring is also available for other temperature regulation couplings.

Other special seals (e.g. EPDM, FFKM) on request.

The TempSecure coupling is especially suited for applications which require high levels of safety due to the media used and their high temperature.

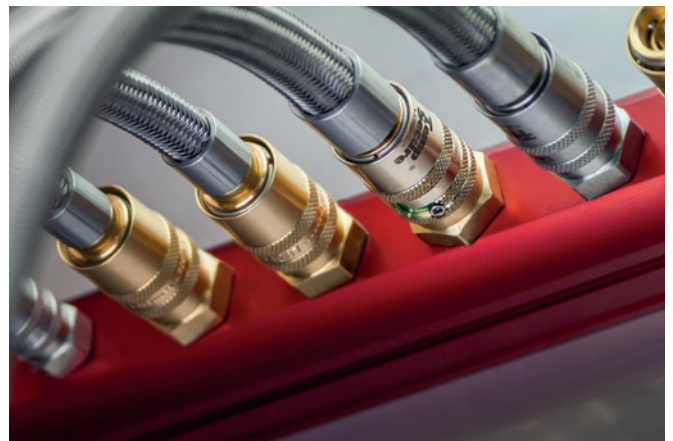

#### The reliable partner for temperature regulation applications

Accidentally decoupled and unlocked?

Not with the TempSecure by **LUDECKE**® product range:

Effective protection against injuries and production downtimes.





# Temperature Regulation Quick Connect Couplings

## Series ESHMT Plug size 9 mm - with Automatic Locking Mechanism

### DN 6

Plug Profile (original size)

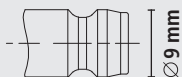

- One-hand quick connect couplings with small dimensions and patented automatic safety locking mechanism
- Forced guidance design with visual colour coding on the locking sleeve
- Combined pressure-torsion spring and strengthened release sleeve made of high resistant special brass
- For temperature regulation applications with warm or hot water as well as tempered oil
- Optional with straight-through, single or double shut-off valves
- To be coupled with plug Series ESHM DN 6
- Versions with additional O-ring sealing at connection port to prevent leakage in high-temperature applications

#### Materials

- Body, valve body, valve: Brass MS 58 plain
- Sleeve: High resistant special brass plain/ nickel-plated
- Plug: Brass MS 58 plain/ nickel-plated
- Balls: Stainless steel 1.4034
- Springs, retaining ring: Stainless steel 1.4310
- Seals: High-Performance FKM

Also in Stainless Steel Series ESHMTE Page 7

European Plug Profile

Max. Working Pressure	Temperature	DN	Thread	Operation	Type of valve	Media	
PN 15 bar	+20°C – +220°C*	6	ISO 228/ DIN 13	One-hand	single/double/straight-thr.	Tempered media	5

#### Couplings with straight standard hose barb without/with valve

Hose connection	L	D	L1	DS	Passage	Weight	Type No w/o valve	Type No. w valve
Hose i.D. 9	61	18	22.5	9	6	58	ESHMT 9 TL	ESHMT 9 TLAB

#### Couplings with 45° standard hose stem without/with valve

Hose connection	L	D	L1	DS	Passage	Weight	Type No w/o valve	Type No. w valve
Hose i.D. 9	54	18	22.5	9	6	82	ESHMT 9 TL45	ESHMT 9 TL45AB

#### Couplings with 90° standard hose stem without/with valve

Hose connection	L	D	L1	DS	Passage	Weight	Type No w/o valve	Type No. w valve
Hose i.D. 9	56	18	22.5	9	6	91	ESHMT 9 TL90	ESHMT 9 TL90AB

#### Couplings with straight male long thread without/with valve (inner cone DIN 3863)

Thread connection	L	SW	D	L1	DS	Passage	Weight	Type No w/o valve	Type No. w valve
G 1/4 m	56.5	17	18	11	9	6	73	ESHMT14AL	ESHMT14ALAB
G 3/8 m	56.5	19	18	11	9	6	76	ESHMT38AL	ESHMT38ALAB
M 14x1.5 m	56.5	17	18	11	9	6	76	ESHMT1415AL	ESHMT1415ALAB
M 16x1.5 m	57	19	18	11	9	6	76	ESHMT1615AL	ESHMT1615ALAB

#### Couplings with 45° male long thread without/with valve (inner cone DIN 3863)

Thread connection	L	SW	D	L1	DS	Passage	Weight	Type No w/o valve	Type No. w valve
G 1/4 m	56	17	18	11	9	6	85	ESHMT14AL45	ESHMT14AL45AB
G 3/8 m	56	17	18	11	9	6	101	ESHMT38AL45	ESHMT38AL45AB
M 14x1.5 m	56	17	18	11	9	6	87	ESHMT1415AL45	ESHMT1415AL45AB
M 16x1.5 m	56	17	18	11	9	6	87	ESHMT1615AL45	ESHMT1615AL45AB

#### Couplings with 90° male long thread without/with valve (inner cone DIN 3863)

Thread connection	L	SW	D	L1	DS	Passage	Weight	Type No w/o valve	Type No. w valve
G 1/4 m	56	17	18	11	9	6	94	ESHMT14AL90	ESHMT14AL90AB
G 3/8 m	56	17	18	11	9	6	100	ESHMT38AL90	ESHMT38AL90AB
M 14x1.5 m	56	17	18	11	9	6	96	ESHMT1415AL90	ESHMT1415AL90AB
M 16x1.5 m	56	17	18	11	9	6	96	ESHMT1615AL90	ESHMT1615AL90AB

Other types/ sizes on request

\*subject to media (oil: 220°C, water: 180°C, air: 220°C)

# Temperature Regulation Quick Connect Couplings

plug size 9 mm – Stainless Steel 1.4305 with Automatic Locking Mechanism

**Series ESHMTE**

- One-hand quick connect couplings with reduced dimensions made of stainless steel 1.4305 and patented automatic safety locking mechanism
- Forced guidance design with visual colour coding on the locking sleeve
- Combined pressure-torsion spring and sleeve made of stainless steel
- For temperature regulation applications with warm or hot water as well as tempered oil e.g. in clean-room applications
- Optional with straight-through, single or double shut-off valves
- Please connect with plug series ESHME DN 6
- Versions with additional O-ring sealing at connection port to prevent leakage in high-temperature applications

## Materials

- Body, sleeve, valve body, valve, plug: Stainless Steel 1.4305
- Springs, retaining ring: Stainless Steel 1.4310
- Balls: Stainless Steel 1.4034
- Seals: High-Performance FKM

Max. Working Pressure	Temperature	DN	Thread	Operation	Type of valve	Media	5
PN 15 bar	+20°C – +220°C*	6	ISO 228/ DIN 13	One-hand	single/double/straight-through	Tempered media	5

**DN 6**

Plug Profile (original size)

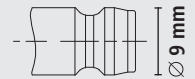

European Plug Profile



## Couplings with straight standard hose stem without/with valve

Hose connection	L	D	L1	DS	Passage	Weight	Type No. w/o. Valve	Type No. w. Valve
Hose i.D. 9	61	18	22.5	9	6	54	ESHMTE 9 TL	ESHMTE 9 TLAB

## Couplings with 45° standard hose stem without/with valve

Hose connection	L	D	L1	DS	Passage	Weight	Type No. w/o. Valve	Type No. w. Valve
Hose i.D. 9	54	18	22.5	9	6	79	ESHMTE 9 TL45	ESHMTE 9 TL45AB

## Couplings with 90° standard hose stem without/with valve

Hose connection	L	D	L1	DS	Passage	Weight	Type No. w/o. Valve	Type No. w. Valve
Hose i.D. 9	56	18	22.5	9	6	88	ESHMTE 9 TL90	ESHMTE 9 TL90AB

## Couplings with straight male long thread without/with valve (inner cone DIN 3863)

Thread connection	L	SW	D	L1	DS	Passage	Weight	Type No. w/o. Valve	Type No. w. Valve
G 1/4 m	56.5	17	18	11	9	6	67	ESHMTE14AL	ESHMTE14ALAB
M 14x1.5 m	56.5	17	18	11	9	6	68	ESHMTE1415AL	ESHMTE1415ALAB

## Couplings with 45° male long thread without/with valve (inner cone DIN 3863)

Thread connection	L	SW	D	L1	DS	Passage	Weight	Type No. w/o. Valve	Type No. w. Valve
G 1/4 m	56	17	18	11	9	6	83	ESHMTE14AL45	ESHMTE14AL45AB
M 14x1.5 m	56	17	18	11	9	6	84	ESHMTE1415AL45	ESHMTE1415AL45AB

## Couplings with 90° male long thread without/with valve (inner cone DIN 3863)

Thread connection	L	SW	D	L1	DS	Passage	Weight	Type No. w/o. Valve	Type No. w. Valve
G 1/4 m	56	17	18	11	9	6	92	ESHMTE14AL90	ESHMTE14AL90AB
M 14x1.5 m	56	17	18	11	9	6	93	ESHMTE1415AL90	ESHMTE1415AL90AB

Other types/ sizes on request

\*subject to media (oil: 220°C, water: 180°C, air: 220°C)

**Temp<sup>®</sup>**  
by **LUDECKE**



# Temperature Regulation Quick Connect Couplings

## Series ESHT Plug size 13 mm – with Automatic Locking Mechanism

DN 9

Plug Profile (original size)

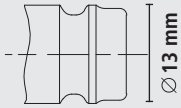

Also in Stainless steel  
Series ESHT E  
Page 9

European  
Plug Profile

- One-hand quick connect couplings with patented automatic safety locking mechanism
- Forced guidance design with visual colour coding on the locking sleeve
- Combined pressure-torsion spring and strengthened release sleeve made of high resistant special brass
- For temperature regulation applications with warm or hot water as well as tempered oil
- Optional with straight-through, single or double shut-off valves
- To be coupled with plug series ESH DN 9
- Versions with additional O-ring sealing at connection port to prevent leakage in high-temperature applications

### Materials

- Body, valve body, valve: Brass MS 58 plain
- Sleeve: high resistant special brass plain/ nickel-plated
- Plug: Brass MS 58 plain/ nickel-plated
- Balls: Stainless steel 1.4034
- Springs, retaining ring: Stainless steel 1.4310
- Seals: High-Performance FKM

Max. Working Pressure	Temperature	DN	Thread	Operation	Type of valve	Media	
PN 15 bar	+20°C – +220°C*	9	ISO 228 / DIN 13 / DIN 158	One-hand	Single/double/straight-through	Tempered media	5

### Couplings with straight standard hose stem without/with valve

Hose connection	L	D	L1	DS	Passage	Weight	Type No. w/o valve	Type No. w valve
Hose i.D. 13	63	23.5	25	13	9	81	ESHT 13 TL	ESHT 13 TLAB

### Couplings with 45° standard hose stem without/with valve

Hose connection	L	SW	D	L1	DS	Passage	Weight	Type No. w/o valve	Type No. w valve
Hose i.D. 13	55.5	22	23.5	25	13	9	138	ESHT 13 TL45	ESHT 13 TL45AB

### Couplings with 90° standard hose stem without/with valve

Hose connection	L	SW	D	L1	DS	Passage	Weight	Type No. w/o valve	Type No. w valve
Hose i.D. 13	55.5	22	23.5	25	13	9	140	ESHT 13 TL90	ESHT 13 TL90AB

### Couplings with straight male long thread without/with valve (inner cone DIN 3863)

Thread connection	L	SW	D	L1	DS	Passage	Weight	Type No. w/o valve	Type No. w valve
G 1/4 m	56	22	23.5	11	13	9	98	ESHT14AL	ESHT14ALAB
G 3/8 m	56	22	23.5	12.5	13	9	94	ESHT38AL	ESHT38ALAB
M 16x1.5 m	56	22	23.5	12.5	13	9	93	ESHT1615AL	ESHT1615ALAB
M 18x1.5 m	56	22	23.5	12.5	13	9	100	ESHT1815AL	ESHT1815ALAB

### Couplings with 45° male long thread without/with valve (inner cone DIN 3863)

Thread connection	L	SW	D	L1	DS	Passage	Weight	Type No. w/o valve	Type No. w valve
G 1/4 m	55.5	22	23.5	11	13	9	130	ESHT14AL45	ESHT14AL45AB
G 3/8 m	55.5	22	23.5	12.5	13	9	134	ESHT38AL45	ESHT38AL45AB
M 16x1.5 m	55.5	22	23.5	12	13	9	132	ESHT1615AL45	ESHT1615AL45AB

### Couplings with 90° male long thread without/with valve (inner cone DIN 3863)

Thread connection	L	SW	D	L1	DS	Passage	Weight	Type No. w/o valve	Type No. w valve
G 1/4 m	55.5	22	23.5	11	13	9	130	ESHT14AL90	ESHT14AL90AB
G 3/8 m	55.5	22	23.5	12.5	13	9	134	ESHT38AL90	ESHT38AL90AB
M 16x1.5 m	55.5	22	23.5	12	13	9	132	ESHT1615AL90	ESHT1615AL90AB

Other types/ sizes on request

\*subject to media (oil: 220°C, water: 180°C, air: 220°C)



# Temperature Regulation Quick Connect Couplings

plug size 13 mm – Stainless Steel 1.4305 with Automatic Locking Mechanism **Series ESHTe**

- One-hand quick connect couplings made of stainless steel 1.4305 with patented automatic safety locking mechanism
- Forced guidance design with visual colour coding on the locking sleeve
- Combined pressure-torsion spring and sleeve made of stainless steel
- For temperature regulation applications with warm or hot water as well as tempered oil e.g. in clean-room applications
- Optional with straight-through, single or double shut-off valves
- Please connect with plug series ESHE DN 9
- Versions with additional O-ring sealing at connection port to prevent leakage in high-temperature applications

## Materials

- Body, sleeve, valve body, valve, plug: Stainless Steel 1.4305
- Springs, retaining ring: Stainless Steel 1.4310
- Balls: Stainless Steel 1.4034
- Seals: High-Performance FKM

Max. Working Pressure	Temperature	DN	Thread	Operation	Type of valve	Media	
PN 15 bar	+20°C – +220°C*	9	ISO 228/ DIN 13	One-hand	single/double/straight-through	Tempered media	5

## Couplings with straight standard hose stem without/with valve

Hose connection	L	D	L1	DS	Passage	Weight	Type No. w/o. Valve	Type No. w. Valve
Hose i.D. 13	63	23.5	25	13	9	77	ESHTe 13 TL	ESHTe 13 TLAB

## Couplings with 45° standard hose stem without/with valve

Hose connection	L	SW	D	L1	DS	Passage	Weight	Type No. w/o. Valve	Type No. w. Valve
Hose i.D. 13	55.5	22	23.5	25	13	9	134	ESHTe 13 TL45	ESHTe 13 TL45AB

## Couplings with 90° standard hose stem without/with valve

Hose connection	L	SW	D	L1	DS	Passage	Weight	Type No. w/o. Valve	Type No. w. Valve
Hose i.D. 13	55.5	22	23.5	25	13	9	134	ESHTe 13 TL90	ESHTe 13 TL90AB

## Couplings with straight male long thread without/with valve (inner cone DIN 3863)

Thread connection	L	SW	D	L1	DS	Passage	Weight	Type No. w/o. Valve	Type No. w. Valve
G 3/8 m	56	22	23.5	12.5	13	9	95	ESHTe38AL	ESHTe38ALAB
M 16x1.5 m	56	22	23.5	12.5	13	9	94	ESHTe1615AL	ESHTe1615ALAB

## Couplings with 45° male long thread without/with valve (inner cone DIN 3863)

Thread connection	L	SW	D	L1	DS	Passage	Weight	Type No. w/o. Valve	Type No. w. Valve
G 3/8 m	55.5	22	23.5	12.5	13	9	131	ESHTe38AL45	ESHTe38AL45AB
M 16x1.5 m	55.5	22	23.5	12.5	13	9	129	ESHTe1615AL45	ESHTe1615AL45AB

## Couplings with 90° male long thread without/with valve (inner cone DIN 3863)

Thread connection	L	SW	D	L1	DS	Passage	Weight	Type No. w/o. Valve	Type No. w. Valve
G 3/8 m	55.5	22	23.5	12.5	13	9	131	ESHTe38AL90	ESHTe38AL90AB
M 16x1.5 m	55.5	22	23.5	12.5	13	9	129	ESHTe1615AL90	ESHTe1615AL90AB

Other types/ sizes on request

\*subject to media (oil: 220°C, water: 180°C, air: 220°C)

# DN 9

Plug Profile (original size)

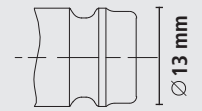

European Plug Profile



**Temp<sup>®</sup> Secure**  
by LUDECKE



NEW!

# Temperature Regulation Quick Connect Couplings

## Series ESHGT Plug size 19 mm – with Automatic Locking Mechanism

**DN 13**

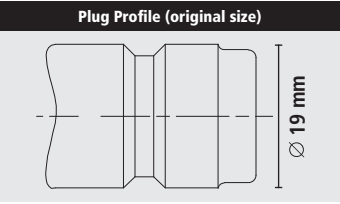

Also in Stainless steel Series ESHGTE Page 11

European Plug Profile

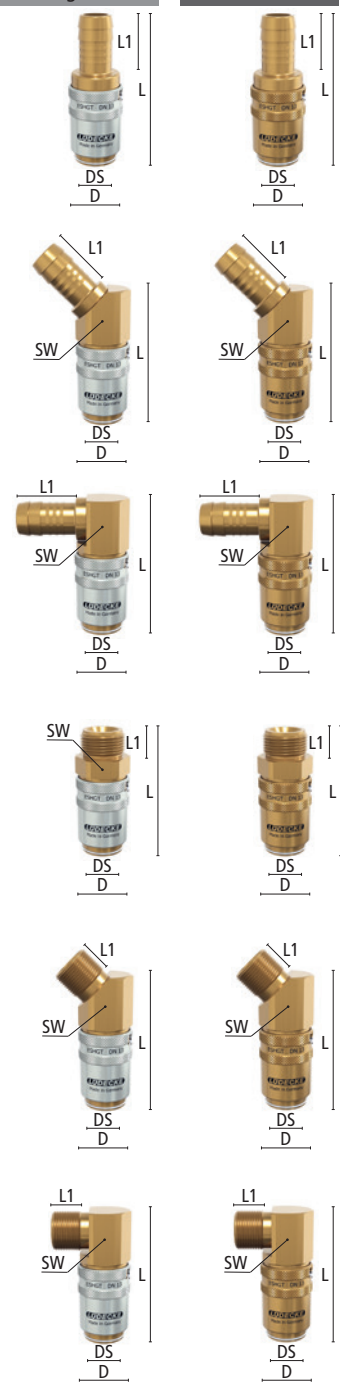

- One-hand quick connect couplings with patented automatic safety locking mechanism
- Forced guidance design with visual colour coding on the locking sleeve
- Combined pressure-torsion spring and strengthened release sleeve made of high resistant special brass
- For temperature regulation applications with warm or hot water as well as tempered oil
- Optional with straight-through, single or double shut-off valves
- To be coupled with plug series ESHG DN 13
- Versions with additional O-ring sealing at connection port to prevent leakage in high-temperature applications

**Materials**

- Body, valve body, valve: Brass MS 58 plain
- Sleeve: High resistant special brass plain/ nickel-plated
- Plug: Brass MS 58 plain/ nickel-plated
- Springs, retaining ring: Stainless steel 1.4310 • Balls: Stainless steel 1.4034 • Seals: High-Performance FKM

Max. Working Pressure	Temperature	DN	Thread	Operation	Type of valve	Media	
PN 15 bar	+20°C – +220°C*	13	ISO 228 / DIN 13	One-hand	Single/double/straight-through	Tempered media	5

**Couplings with straight standard hose stem without/with valve**

Hose connection	L	D	L1	DS	Passage	Weight	Type No. w/o valve	Type No. w valve
Hose i.D. 13	82	32.5	25	19	9	131	ESHGT 13 TL	ESHGT 13 TLAB
Hose i.D. 19	90	32.5	34	19	14	210	ESHGT 19 TL	ESHGT 19 TLAB

**Couplings with 45° standard hose stem without/with valve**

Hose connection	L	SW	D	L1	DS	Passage	Weight	Type No. w/o valve	Type No. w valve
Hose i.D. 13	82	30	32.5	25	19	9	131	ESHGT 13 TL45	ESHGT 13 TL45AB
Hose i.D. 19	90	30	32.5	34	19	14	210	ESHGT 19 TL45	ESHGT 19 TL45AB

**Couplings with 90° standard hose stem without/with valve**

Hose connection	L	SW	D	L1	DS	Passage	Weight	Type No. w/o valve	Type No. w valve
Hose i.D. 13	82	30	32.5	25	19	9	131	ESHGT 13 TL90	ESHGT 13 TL90AB
Hose i.D. 19	90	30	32.5	34	19	14	210	ESHGT 19 TL90	ESHGT 19 TL90AB

**Couplings with straight male long thread without/with valve (inner cone DIN 3863)**

Thread connection	L	SW	D	L1	DS	Passage	Weight	Type No. w/o valve	Type No. w valve
G 1/2 m	76	30	32.5	15	19	13	226	ESHGT12AL	ESHGT12ALAB
G 3/4 m	77	30	32.5	16	19	13	252	ESHGT34AL	ESHGT34ALAB
M 24x1.5 m	77	30	32.5	16	19	13	242	ESHGT2415AL	ESHGT2415ALAB

**Couplings with 45° male long thread without/with valve (inner cone DIN 3863)**

Thread connection	L	SW	D	L1	DS	Passage	Weight	Type No. w/o valve	Type No. w valve
G 1/2 m	81	30	32.5	16	19	13	332	ESHGT12AL45	ESHGT12AL45AB
G 3/4 m	81	30	32.5	16	19	13	357	ESHGT34AL45	ESHGT34AL45AB
M 24x1.5 m	81	30	32.5	17	19	13	348	ESHGT2415AL45	ESHGT2415AL45AB

**Couplings with 90° male long thread without/with valve (inner cone DIN 3863)**

Thread connection	L	SW	D	L1	DS	Passage	Weight	Type No. w/o valve	Type No. w valve
G 1/2 m	81	30	32.5	16	19	13	334	ESHGT12AL90	ESHGT12AL90AB
G 3/4 m	81	30	32.5	16	19	13	361	ESHGT34AL90	ESHGT34AL90AB
M 24x1.5 m	81	30	32.5	17	19	13	350	ESHGT2415AL90	ESHGT2415AL90AB

Other types/ sizes on request

\*subject to media (oil: 220°C, water: 180°C, air: 220°C)



# Temperature Regulation Quick Connect Couplings

plug size 19 mm – Stainless Steel 1.4305 with Automatic Locking Mechanism **Series ESHGTE**

- One-hand quick connect couplings made of stainless steel 1.4305 with patented automatic safety locking mechanism
- Forced guidance design with visual coding on the locking sleeve
- Combined pressure-torsion spring and sleeve made of stainless steel
- **For temperature regulation applications with warm or hot water as well as tempered oil e.g. in clean-room applications**
- Optional with straight-through, single or double shut-off valves
- Versions with additional O-ring sealing at connection port to prevent leakage in high-temperature applications

### Materials

- Body, sleeve, valve body, valve, plug: Stainless Steel 1.4305
- Springs, retaining ring: Stainless Steel 1.4310
- Balls: Stainless Steel 1.4034
- Seals: High-Performance FKM

Max. Working Pressure	Temperature	DN	Thread	Operation	Type of valve	Media	
PN 15 bar	+20°C – +220°C*	13	ISO 228/ DIN 13	One-hand	single/double/ straight-through	Tempered media	5

### Couplings with straight standard hose stem without/with valve

Hose connection	L	D	L1	DS	Passage	Weight	Type No. w/o. Valve	Type No. w. Valve
Hose i.D. 13	82	34	25	19	9.5	221	ESHGTE 13 TL	ESHGTE 13 TLAB
Hose i.D. 19	90	34	34	19	14	239	ESHGTE 19 TL	ESHGTE 19 TLAB

### Couplings with straight male long thread without/with valve (inner cone DIN 3863)

Thread connection	L	SW	D	L1	DS	Passage	Weight	Type No. w/o. Valve	Type No. w. Valve
G 1/2 m	76	30	34	15	19	13	255	ESHGTE 12 A	ESHGTE 12 AAB
G 3/4 m	77	30	34	16	19	13	279	ESHGTE 34 A	ESHGTE 34 AAB
M 24x1.5 m	77	30	34	16	19	13	269	ESHGTE 2415 A	ESHGTE 2415 AAB

### Couplings with straight female thread without/with valve

Thread connection	L	SW	D	L1	DS	Passage	Weight	Type No. w/o. Valve	Type No. w. Valve
G 1/2 f	69.5	27	34	12	19	13	238	ESHGTE 12 I	ESHGTE 12 IAB
G 3/4 f	69.5	32	34	12	19	13	244	ESHGTE 34 I	ESHGTE 34 IAB
M 24x1.5 f	69.5	32	34	12	19	13	240	ESHGTE 2415 I	ESHGTE 2415 IAB

### Plugs with standard hose stem without valve

Hose connection	L	L1	L2	DS	Passage	Weight	Type No.
Hose i.D. 13	54	25	27	19	9	52	ESHGE 13 SL
Hose i.D. 19	63	34	27	19	13	81	ESHGE 19 SL

### Plugs with straight male thread without valve (inner cone DIN 3863)

Thread connection	L	SW	L1	L2	DS	Passage	Weight	Type No.
G 1/2 m	47	22	12	27	19	13	64	ESHGE 12 NA
G 3/4 m	51	27	16	27	19	13	107	ESHGE 34 NA
M 24x1.5 m	51	27	16	27	19	13	97	ESHGE 2415 NA

### Plugs with straight female thread without valve

Thread connection	L	SW	L1	L2	DS	Weight	Type No.
G 1/2 f	42	27	10	27	19	72	ESHGE 12 NI
G 3/4 f	42.5	32	10	27	19	86	ESHGE 34 NI

Other sizes on request

\*subject to media (oil: 220°C, water: 180°C, air: 220°C)

**DN 13**

Plug Profile (original size)

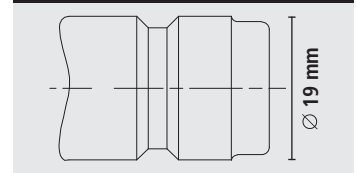

European Plug Profile





# Temperature Regulation Quick Connect Couplings

## Series ESDMT Plug size 9.4 mm – with Automatic Locking Mechanism

**DN 6**

Plug Profile (original size)

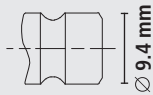

International Plug Profile

- One-hand quick connect couplings with small dimensions and patented automatic safety locking mechanism
- Forced guidance design with visual colour coding on the locking sleeve
- Combined pressure-torsion spring and strengthened release sleeve made of high resistant special brass
- For temperature regulation applications with warm or hot water as well as tempered oil
- Optional with straight-through, single or double shut-off valves
- To be coupled with plug series ESDM DN 6
- Versions with additional O-ring sealing at connection port to prevent leakage with high-temperature applications

### Materials

- Body, valve body, valve: Brass MS 58 plain
- Sleeve: High resistant special brass plain/ nickel-plated
- Plug: Brass MS 58 plain/ nickel-plated
- Springs, retaining ring: Stainless steel 1.4310 • Balls: Stainless steel 1.4034 • Seals: High-Performance FKM

Max. Working Pressure	Temperature	DN	Thread	Operation	Type of valve	Media	
PN 15 bar	+20°C – +220°C*	6	ISO 228/ DIN 13	One-hand	Single/double/straight-thr.	Tempered media	5

### Couplings with straight standard hose stem without/with valve

Hose connection	L	D	L1	DS	Passage	Weight	Type No. w/o valve	Type No. w valve
Hose i.D. 9	60	18	22.5	9.4	6	55	ESDMT 9 TL	ESDMT 9 TLAB

### Couplings with 45° standard hose stem without/with valve

Hose connection	L	D	L1	DS	Passage	Weight	Type No. w/o valve	Type No. w valve
Hose i.D. 9	51	18	22.5	9.4	6	78	ESDMT 9 TL45	ESDMT 9 TL45AB

### Couplings with 90° standard hose stem without/with valve

Hose connection	L	D	L1	DS	Passage	Weight	Type No. w/o valve	Type No. w valve
Hose i.D. 9	55	18	22.5	9.4	6	87	ESDMT 9 TL90	ESDMT 9 TL90AB

### Couplings with straight male long thread without/with valve (inner cone DIN 3863)

Thread connection	L	SW	D	L1	DS	Passage	Weight	Type No. w/o valve	Type No. w valve
G 1/4 m	55.5	17	18	11	9.4	6	69	ESDMT14AL	ESDMT14ALAB
M 14x1.5 m	55.5	17	18	11	9.4	6	70	ESDMT1415AL	ESDMT1415ALAB

### Couplings with 45° male long thread without/with valve (inner cone DIN 3863)

Thread connection	L	SW	D	L1	DS	Passage	Weight	Type No. w/o valve	Type No. w valve
G 1/4 m	51	17	18	11	9.4	6	81	ESDMT14AL45	ESDMT14AL45AB
M 14x1.5 m	51	17	18	11	9.4	6	82	ESDMT1415AL45	ESDMT1415AL45AB

### Couplings with 90° male long thread without/with valve (inner cone DIN 3863)

Thread connection	L	SW	D	L1	DS	Passage	Weight	Type No. w/o valve	Type No. w valve
G 1/4 m	55	17	18	11	9.4	6	90	ESDMT14AL90	ESDMT14AL90AB
M 14x1.5 m	55	17	18	11	9.4	6	91	ESDMT1415AL90	ESDMT1415AL90AB

Other types/ sizes on request

\*subject to media (oil: 220°C, water: 180°C, air: 220°C)

# Temperature Regulation Quick Connect Couplings

Plug size 13.5 mm – with Automatic Locking Mechanism **Series ESDT**

- One-hand quick connect couplings with patented automatic safety locking mechanism
- Forced guidance design with visual colour coding on the locking sleeve
- Combined pressure-torsion spring and strengthened release sleeve made of high resistant special brass
- **For temperature regulation applications with warm or hot water as well as tempered oil**
- Optional with straight-through, single or double shut-off valves
- To be coupled with plug series ESD DN 9
- Versions with additional O-ring sealing at connection port to prevent leakage in high-temperature applications

## Materials

- Body, valve body, valve: Brass MS 58 plain
- Sleeve: High resistant special brass plain/ nickel-plated
- Plug: Brass MS 58 plain/ nickel-plated
- Balls: Stainless steel 1.4034
- Springs, Retaining ring: Stainless steel 1.4310
- Seals: High-Performance FKM

Max. Working Pressure	Temperature	DN	Thread	Operation	Type of valve	Media	
PN 15 bar	+20°C – +220°C*	9	ISO 228/ DIN 13	One-hand	Single/double/straight-through	Tempered media	5

## Couplings with straight standard hose stem without/with valve

Hose connection	L	D	L1	DS	Passage	Weight	Type No. w/o valve	Type No. w valve
Hose i.D. 13	64.5	24	25	13.5	9	94	ESDT 13 TL	ESDT 13 TLAB

## Couplings with 45° standard hose stem without/with valve

Hose connection	L	D	L1	DS	Passage	Weight	Type No. w/o valve	Type No. w valve
Hose i.D. 13	57	24	25	13.5	9	147	ESDT 13 TL45	ESDT 13 TL45AB

## Couplings with 90° standard hose stem without/with valve

Hose connection	L	D	L1	DS	Passage	Weight	Type No. w/o valve	Type No. w valve
Hose i.D. 13	57	24	25	13.5	9	149	ESDT 13 TL90	ESDT 13 TL90AB

## Couplings with straight male long thread without/with valve (inner cone DIN 3863)

Thread connect.	L	SW	D	L1	DS	Passage	Weight	Type No. w/o valve	Type No. w valve
G 3/8 m	57.5	22	24	12.5	13.5	9	108	ESDT38AL	ESDT38ALAB
M 16x1.5 m	57.5	22	24	12.5	13.5	9	107	ESDT1615AL	ESDT1615ALAB

## Couplings with 45° male long thread without/with valve (inner cone DIN 3863)

Thread connect.	L	SW	D	L1	DS	Passage	Weight	Type No. w/o valve	Type No. w valve
G 3/8 m	57	22	24	12.5	13.5	9	144	ESDT38AL45	ESDT38AL45AB
M 16x1.5 m	57	22	24	12.5	13.5	9	140	ESDT1615AL45	ESDT1615AL45AB

## Couplings with 90° male long thread without/with valve (inner cone DIN 3863)

Thread connect.	L	SW	D	L1	DS	Passage	Weight	Type No. w/o valve	Type No. w valve
G 3/8 m	57	22	24	12.5	13.5	9	146	ESDT38AL90	ESDT38AL90AB
M 16x1.5 m	57	22	24	12.5	13.5	9	143	ESDT1615AL90	ESDT1615AL90AB

Other types / sizes on request

\*subject to media (oil: 220°C, water: 180°C, air: 220°C)

**DN 9**

Plug Profile (original size)

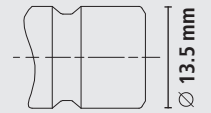

International Plug Profile

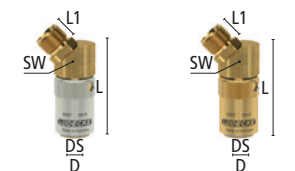
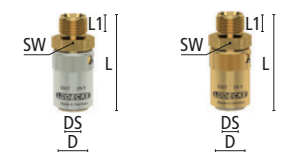
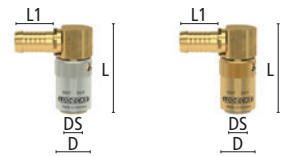
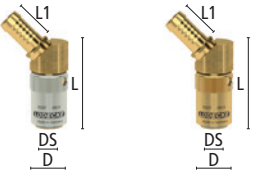

**Temp<sup>®</sup>**  
by **LUDECKE**



**LÜDECKE**

**LÜDECKE**

Since 1930. The perfect connection.

**LÜDECKE** GmbH - Heinrich-Hauck-Str. 2 - D-92224 Amberg - Phone: +49 9621 7682 0  
info@luedecke.de - www.luedecke.de